

PUSH ROD

The SafeGauge Push Rod gives a displacement measurement between two fixed points. The articulating magnetic mounts allow a quick and secure setup on machinery.

1. Connecting

Press the power button to turn on the Push Rod sensor. (Turn off when not in use).



Tap the sensor icon on the MultiTool Pro to connect.



2. Mounting

Mount the Push Rod sensor perpendicular to the axis of movement being measured and place the transmitter box on the machine nearby.

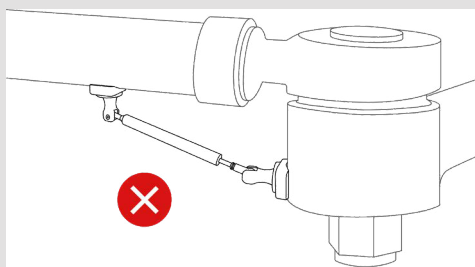
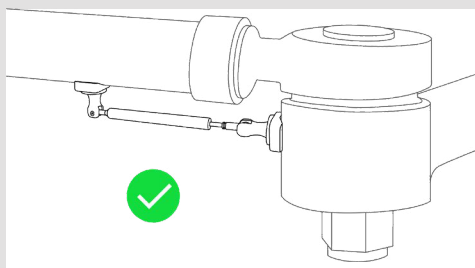

The sensor should be in the centre of its movement. (Showing close to 25mm on the MultiTool Pro).



If you have any questions or concerns with the usability of SafeGauge products, please don't hesitate to reach out to us on 1300 222 392. We appreciate your feedback to help improve our products and our customers satisfaction and safety when completing live work.

3. Measuring



View the reading on the MultiTool Pro.

Press Reset once in position to zero the sensor.

4. Removing

To remove the Push Rod, grab the black end joints and pull off at an angle to prevent damage.

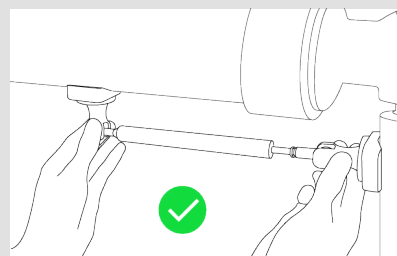

Do not grab the shaft to remove sensor. Only remove by grabbing the end joints.

