



Technical Data Sheet



**Maximise
Safety**



**Eliminate
Live Work**



**Wireless up to
100m (328ft)**

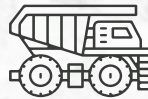

**Purpose Built for
Heavy Industry**

Overview

The **SafeGauge Pressure Transducer (PT)** allows workers to measure fluid and gas pressure safely and efficiently. With a Bluetooth range of 100 meters (328ft), the PT can connect to the MultiTool Pro. The LED on the PT will flash blue when scanning and green when connected to a MultiTool Pro.

The PT can be identified by its unique serial, product number and colour. Each pressure reading is displayed with a custom title on the MultiTool Pro. Through the MultiTool Pro, the data can be displayed in psi, kPa, bar, MPa, Kg/cm² or inHg.

Applications

- Fault finding/diagnostics
- Gas pressure testing
- Hydraulic pressure testing
- Engine pressure testing

Capability

- Wireless Pressure Transducer (PT)
- Available in 2 - 7 Channel Kits
- Up to 100m (328ft) Bluetooth Range
- Eliminates Live Work (ELW)
- Test Multiple Sensors Simultaneously
- 30 Hour Battery Life

Pressure Range

The SafeGauge Pressure Transducer is available in different pressure ranges.

The pressure range is engraved (in bar) on the stainless steel base of the transducer. The part number is also shown on the display when connected to a MultiTool Pro, indicating the pressure range.
(Example: PT600=600bar).

Specifications:

Electrical	
Power connector	5V DC jack (contained within kit)
Battery type	Nickel Metal Hydride
Charging	to be charged by SafeGauge charging case only
Operating time	30 hours/full charge
LED system	Flashes blue when searching to connect, and green when connected
Battery technology	Internal NiMh (Nickel Metal Hydride) 2.4 volt pack
Battery life cycle	1,000 charging cycles
Charging time	3 hours (from zero to full charge)

Mechanical	
Dimensions	32mm (diameter) x 100mm (length) (1.26in x 3.94in)
Weight	160g (5.6oz)
Connector thread size	1/4" NPT
Pressure measurement range	0-600bar (0-8700psi)
Maximum pressure	0-25bar (363 psi) 0-100bar (1450 psi) 0-300bar (4351 psi) 0-600bar (8700 psi) If you cannot identify a pressure transducer, contact us on 1300 222 392
Suitable materials	Oil & Gas (Grease not recommended)
Accuracy full scale	0.2% Full scale
Max fluid temperature	85°C (185°F)
Sensor operating temperature	0-65°C (32 - 149°F)
Sensor charging temperature	0-60°C (32-140°F)
Thermal error	Less than 0.02% of full scale per degree Celsius
Calibrated temperature	19.8 (67.64 deg F) +/- 0.2°C (0.36 deg F)
Wrench size	27mm (1in)
Torque specification	47.5Nm (35ft-lbs)
Pressure transducer ageing	Less than 0.2% of full scale per year
Calibration	to be performed by SafeGauge only

Communication	
Radio type	Bluetooth Low Energy (BLE)
Maximum range	Up to 100m (328ft)

Environmental	
Battery disposal	When finished with a SafeGauge product please return to SafeGauge Pty Ltd for correct recycling, or follow your local area laws and guidelines for correct battery disposal.
Oil Spills	When connecting the PT, follow the OEM guidelines on the machine to minimise risk of oil spills.

DISCLAIMER - While every effort has been made to ensure the accuracy of this document at the date of issue, SafeGauge assumes no liability resulting from any omissions or errors in this document, and reserves the right to revise content at any time.

Dimensions

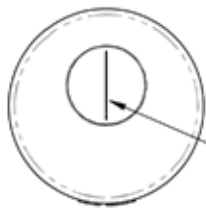

WATERPROOF QUICK-SEAL
1/4" NPT FOR CHARGING



PICTORIAL VIEWS

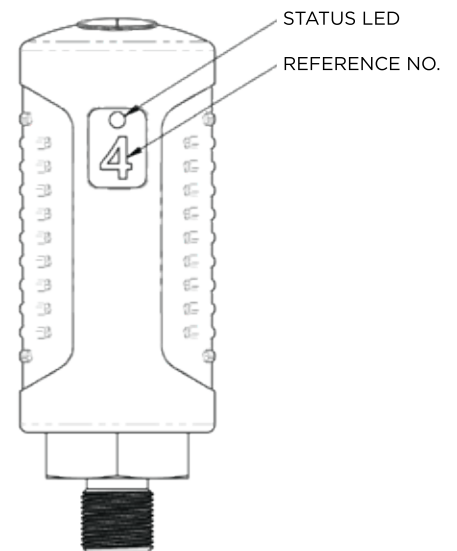
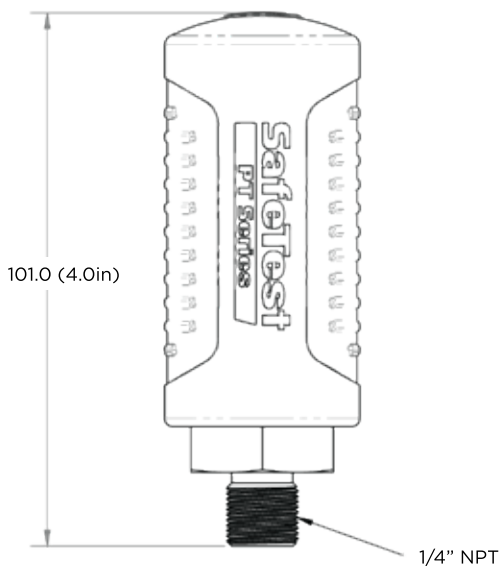

Compliance

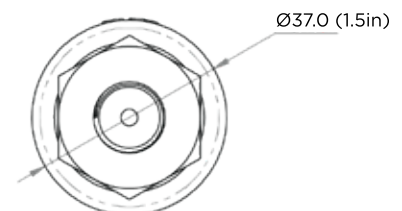

DISCLAIMER - While every effort has been made to ensure the accuracy of this document at the date of issue, SafeGauge assumes no liability resulting from any omissions or errors in this document, and reserves the right to revise content at any time.